

Setting the motor run timer

Compatible Products:



1870142
Integrated
DC RTS receiver



1870137
DC RTS
receiver



1870158
Power 2.5
DC RTS



1870162
Power 4 x 2.5
DC RTS

COMPLETE ALL SECTIONS

Pair handset with receiver

Module DC RTS Shown

Press the program button for approximately 3 seconds



Press for 3 secs



The blind will jog

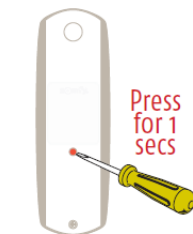

Telis RTS

Press for 1 secs



Jog =
Control recorded

1) Enter the maintenance mode

Whilst in 'User Mode', press and hold simultaneously the Up and Down buttons until the blind(s) jog (approximately 5 seconds).

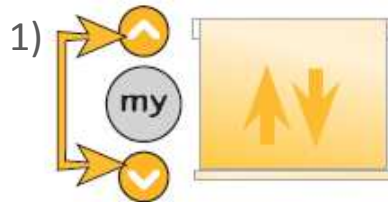

You are now in 'Maintenance Mode'. Adjustments can now be made to modify specific settings.

Reversing the motor direction

If the motor is running in the wrong direction, i.e. up is down and down is up, reverse the direction of the motor.

Press and hold the Stop button until the blind(s) jog.



Motor direction reversed

2) Setting the motor run time

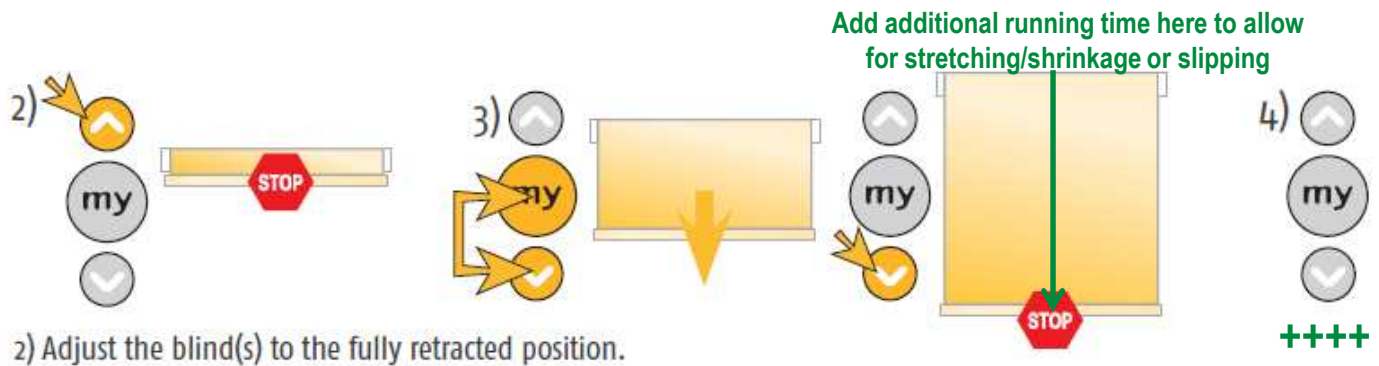

2) Adjust the blind(s) to the fully retracted position.

3) Briefly press and release the My and Down buttons: the blind(s) will extend for 10 seconds and stop (the blinds can be stopped within this 10 second time period by pressing the Stop button). To continue to extend the blind(s), press and hold the Down button until the blind(s) reach the end limit position.

 *Nb: Only the length of time the button is held is saved. Time is not measured once the blind(s) have stopped.*

4) Once the blind(s) have reached the fully extended position, release the Down button. +++++

 *Nb: If the Down button remains held once the fully extended position is reached, time continues to be measured and the blind does not move - this time will be added to the 'extend' run timer delay.*

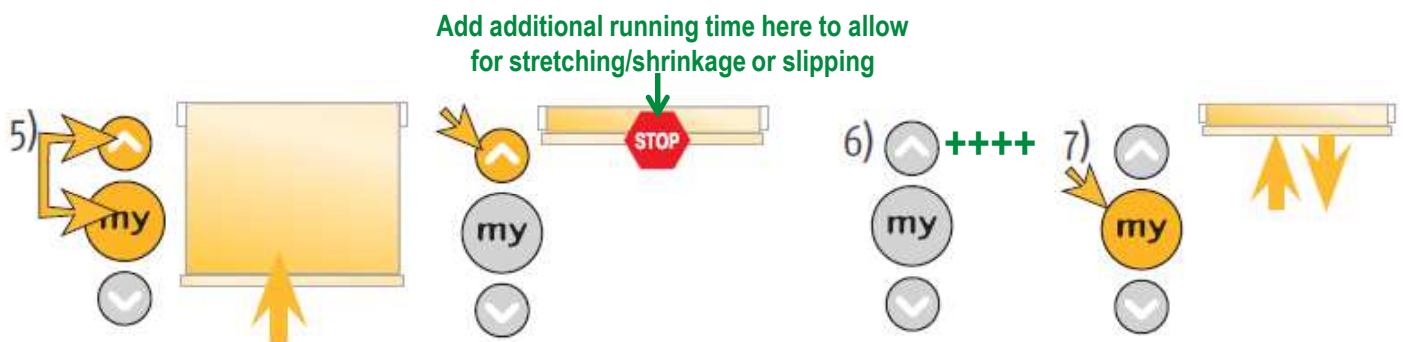

5) Briefly press and release the My and Up buttons: The blind(s) retract for 10 seconds and stop. (the blinds can be stopped within this 10 second time period by pressing the Stop button).

Nb: Pressing the My and Up buttons confirms the 'extend' motor run time duration.

To continue to retract the blind(s), press and hold the Up button until the blind(s) reach the end limit position.

 *Nb: Only the length of time the button is held is saved. Time is not measured once the blind(s) have stopped.*

6) Once the blind(s) have reached the fully retracted position, release the Up button. +++++

 *Nb: If the Up button remains held once the fully retracted position is reached, time continues to be measured and the blind does not move - this time will be added to the 'retract' run timer delay.*

7) To record the motor run timer delays, press the My button for approximately 2 seconds until the blind(s) jog.

8) Exit the maintenance mode

Whilst in 'Maintenance Mode', press and hold the Stop button until the blind(s) jog twice (approximately 5 seconds).



You have now exited 'Maintenance Mode' and have reverted back to 'User Mode'

Activating the motor run timer

Activating the motor run time

- 1 Press and hold simultaneously the Up, Stop and Down buttons until the blind(s) jog.
- 2 Press and hold simultaneously the Stop and Down buttons until the blind(s) jog.
- 3 Press and the Down button until the blind(s) jog.
- 4 Press and hold the Stop button until the blind(s) jog.

Delete Default *my* position

Delete default *my* position

A *my* position is set by default and should be deleted to ensure correct operation.

- 1 Press the Stop button and the blind will travel to the set *my* position.
- 2 Press and hold the Stop button until the blind(s) jog.

Reset/Wipe Receiver

Reset/Wipe Receiver

If there is a need to reset the system and wipe the memory of the receiver press the program button on the receiver and hold in until blind has made 3 jogs.

Module DC RTS Shown



The blind will jog